

PRINCETON UNIVERSITY ART MUSEUM

UPPER GALLERIES

1. Front Lobby Entrance
2. Museum Shop/Information
3. Contemporary Painting and Sculpture
4. European Art: Baroque and Neo-Classicism, 17th–19th Centuries
5. American Painting & Sculpture: 18th–19th Centuries
6. Contemporary Painting & Sculpture
7. Special Exhibitions
8. Impressionism & Post-Impressionism
9. European & American Art: 19th Century
10. European & American Art: Early 20th Century
11. Northern & Italian Renaissance: 13th–16th Centuries
12. European Art: 16th–17th Centuries
13. European Art: 17th–18th Centuries
14. Medieval, Byzantine, and Islamic Art



LOWER GALLERIES

1. Security Booth; ♿ Entrance
2. Chinese Art
3. Southeast Asian Art
4. Japanese Art
5. African Art
6. Pre-Columbian Art & Art of the Americas
7. Ancient Art
8. Ancient Art Study Storage

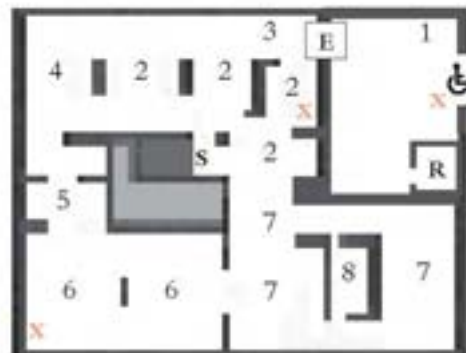

- E = elevator
- L = ♿ lift
- S = stairs
- R = restroom
- X = emergency exit